



Selected portfolio

# WALDNER EDUCATION

LEARNING SPACES FOR TOMORROW'S EDUCATION

**WALDNER**



# WALDNER EDUCATION



Established in 1879



Production in Germany

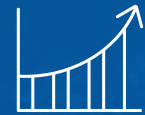

Innovation & market leader



From junior via higher education to universities



Laboratory furniture & education product portfolio



## WHAT WE OFFER



### SAFETY

- › Highest safety standards achieved
- › Constant evaluation and improvement process



### QUALITY

- › Made in Germany
- › Long lifecycle raw materials & products



### FLEXIBILITY

- › Modular ceiling supply systems
- › Movable furniture
- › Adaptable and reconfigurable structures
- › Future-proof



### CONSULTATION AND PLANNING

All projects start with the creation of an optimal solution for your individual needs and our experts are on hand to support.



### PRODUCTION AND INSTALLATION

We guarantee top manufacturing technology and professional installation.



### MAINTENANCE AND SERVICE

Our service team will quickly be at your side to provide you with advice and support.



# THE FUTURE DEMANDS A VARIETY OF TEACHING METHODS

- + FOR THE STUDY OF CLASSICAL AND CONTEMPORARY TOPICS
- + TO IMPROVE LEARNING SUCCESS
- + TO SUPPORT 21ST CENTURY SKILLS ACQUIREMENT
- + TO EASE ACTIVE LEARNING BY EXPERIMENTING AND PRACTICING



The room should be the third pedagogue



Create a new learning culture - From knowledge transfer to competence development



## SUPPORT OF 21ST CENTURY SKILLS

The task of educational institutions in the 21st century is to support students with the development of their individual personalities and competencies which are the skills needed for lifelong learning.





# OUR MULTIFUNCTIONAL ROOM CONCEPT PORTFOLIO

"Please build rooms that prohibit fall back to old pedagogical times!"

Dr. Peter Rösner,  
Head of Foundation  
Louisenlund

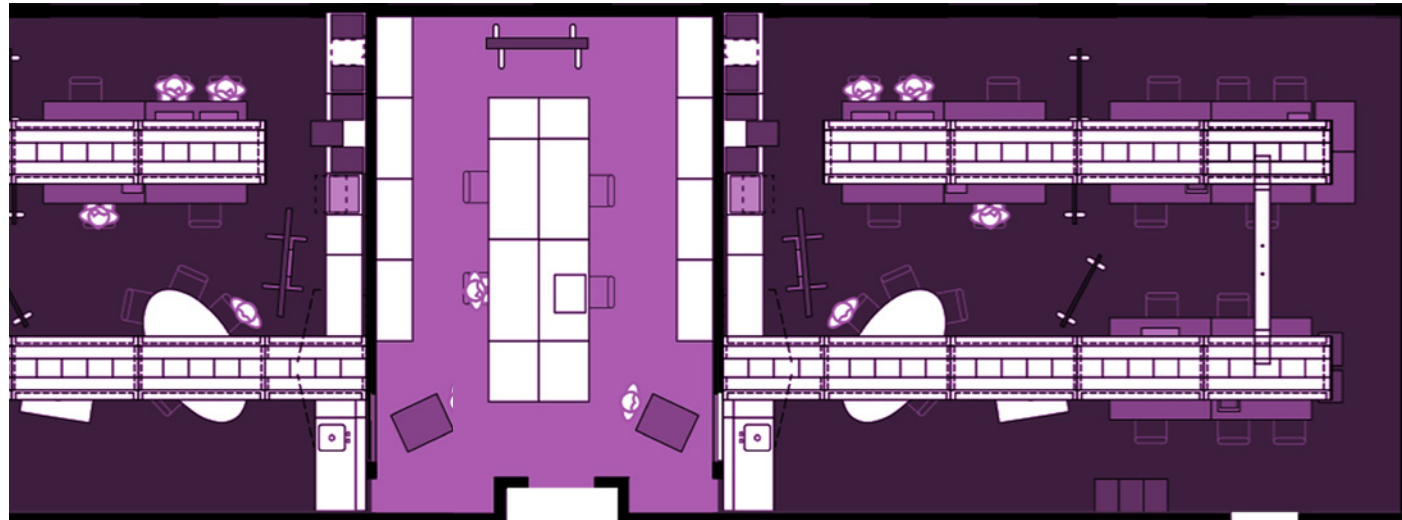

## PREP ROOMS AND STEM LABS

Our collection of ceiling systems and laboratory equipment provides industry leading professional quality.

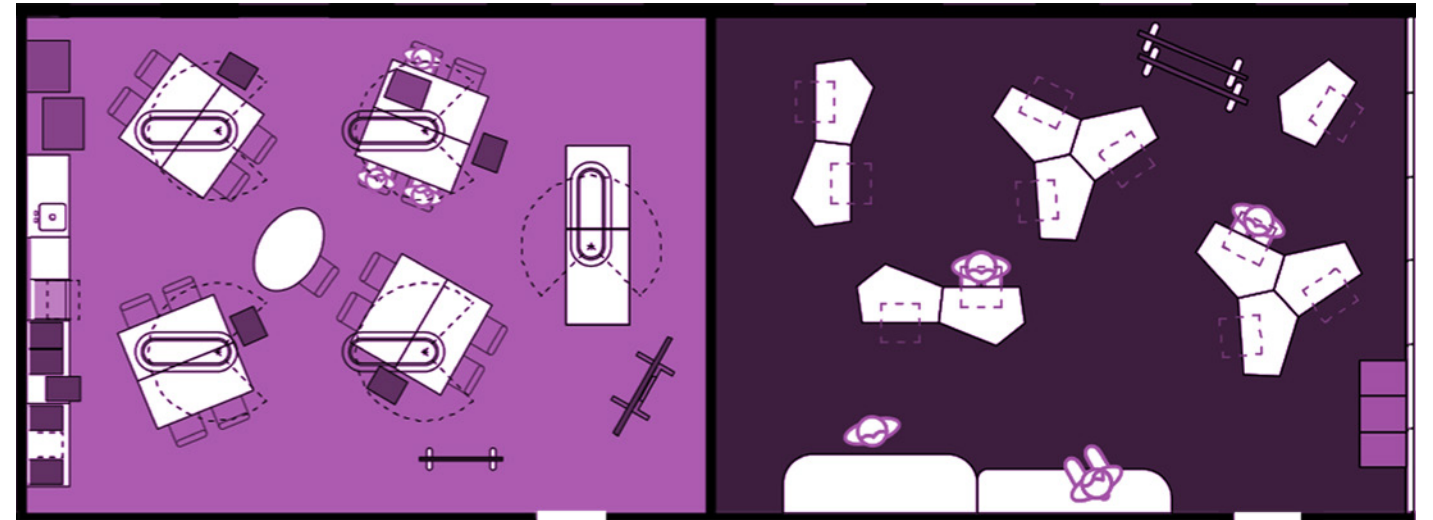

## MAKERSPACES

Problem solving and collaboration is supported by flexible and adaptable product.



## GENERAL CLASSROOMS

In the General classroom our FlexLearn system of mobile cabinets, tables and ergonomic seating supports a dynamic learning experience.







Only a flexible environment can support the needs of developing education.

## WHY DO WE THINK IN ROOM CONCEPTS?

### IT IS IMPORTANT TO:

- › Create a stimulating and inspiring environment for teachers and students
- › Accommodate different learning styles
- › Allow rapid layout changes for partner and group work for a positive learning experience



### IMPLEMENT YOUR IDEAS

Encourage innovative thinking and new ideas from your students and employees. A short brainstorming session or a workshop on selected topics can deliver outstanding results. It also reinforces cooperation and provides motivation for the future.



### MINIMAL SPACE REQUIREMENT

Our room concepts save space. The modular furniture teamed with intelligent layout ensures that maximum use is made of the available space and nothing is wasted.



### OUTSTANDING EFFICIENCY

Make the most of a versatile furnishing concept and take advantage of the many diverse uses offered by our room concepts. Reduce your space requirements and improve your performance.



### FLEXIBILITY

Our room concepts lower costs as the flexible supply of services allows for many different uses in the same space thereby reducing the need for purposebuilt individual rooms.



# COST REDUCTION

THINK INVESTMENT AND NOT COST

COMPARISON OF ROOM OCCUPANCY

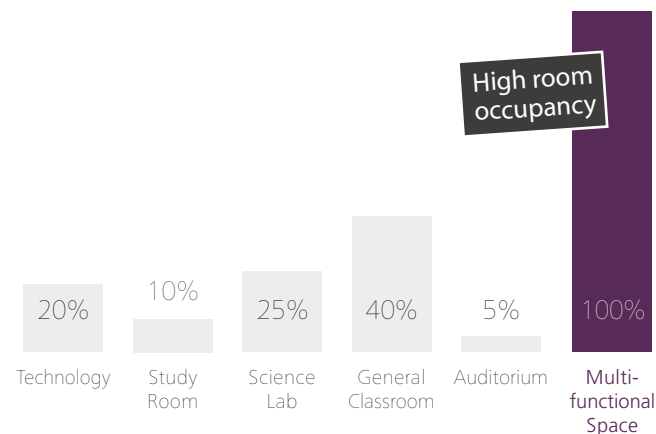

→ Enhanced performance

COMPARISON OF SPACE REQUIREMENT

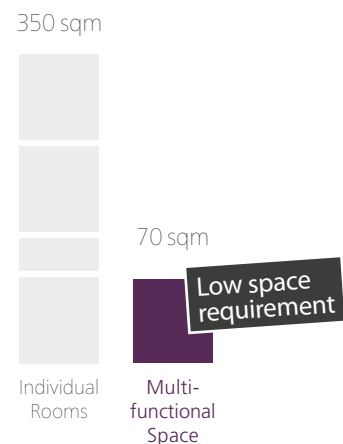

→ Lower costs

- + FUTURE-PROOF AND SUSTAINABLE PRODUCTS
- + MOBILE INFRASTRUCTURE IS EASILY RE-LOCATABLE
- + GENERIC USAGE OF CLASSROOMS
- + FAST ON-SITE INSTALLATION
- + REDUCED CONSTRUCTION COSTS
- + MINIMAL MAINTENANCE
- + RE-INVEST IN EDUCATION

## HOW AND WHY?

Multi-functional space

- › You will need less space as dedicated rooms are used less often than a multifunctional space
- › Protect your budget by reducing costs and benefit from a higher return on your investment

Modular and re-locatable products

- › High quality equipment that can be used in multiple locations and over a long period of time
- › Sustainability is the key to our future

Factory production

- › Reduce the time, complexity and cost required for multi-discipline construction work
- › Precision equipment that is factory assembled can be installed in a short time by our dedicated team and will reduce all costs associated with your project

ONE MORNING: ONE ROOM AND THREE DIFFERENT USES





# FLY ONE

MAXIMUM FLEXIBILITY AND ELEGANT DESIGN

FLEXIBILITY IN 4 DIMENSIONS



**MEDIA**

Compressed air, gas, lighting, multimedia and power

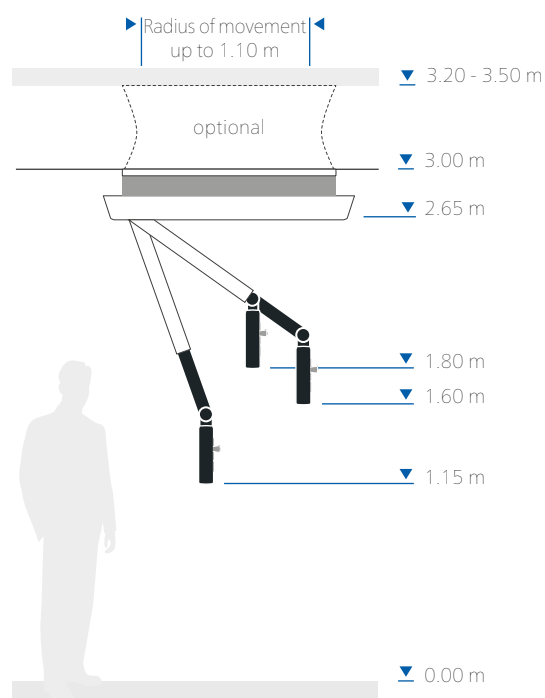

+ AVAILABLE AS CEILING LIGHT ONLY - FLY LIGHT

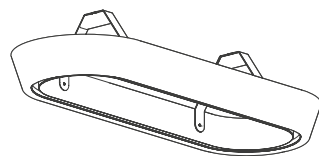

- + THREE-DIMENSIONAL NAVIGATION
- + DIMMABLE HIGH-POWER LED LIGHTING
- + ERGONOMIC MEDIA SUPPLY WITH INDIVIDUAL HEIGHT ADJUSTMENT
- + FULLY AUTOMATIC EXTENSION AND RETRACTION





# MEDIA WING

THE ULTIMATE SOLUTION FOR EVERY STEM LAB

- + MAXIMUM VARIABILITY
- + HIGHEST FLEXIBILITY AND SAFETY
- + MODULAR DESIGN & CONSTRUCTION
- + VARIETY OF ACCESSORIES FOR HIGH-QUALITY AND SAFE EXPERIMENTS

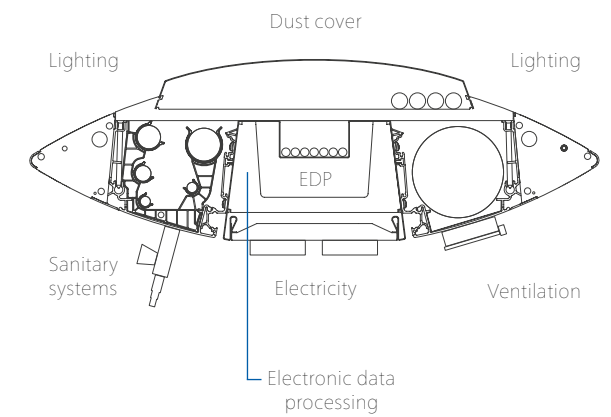

**MEDIA**

Compressed air, gas, lighting, multimedia, power, exhaust air, high volume vacuum, water delivery and removal



- + MANUAL OPERATION FOR INSTANT ACCESS
- + ERGONOMIC AND SLIM DESIGN
- + HIGH CAPACITY DELIVERY – UP TO 13 MEDIA OUTLETS PER ARM
- + ROBUST AND SAFE FOR HIGH VOLUME OPERATION
- + SERIAL LINKED OR INDIVIDUAL FOR THE SMALLER ROOM

MEDIA

Compressed air, gas, lighting, multimedia and power

# POWERLIFT

THE BUDGET SOLUTION

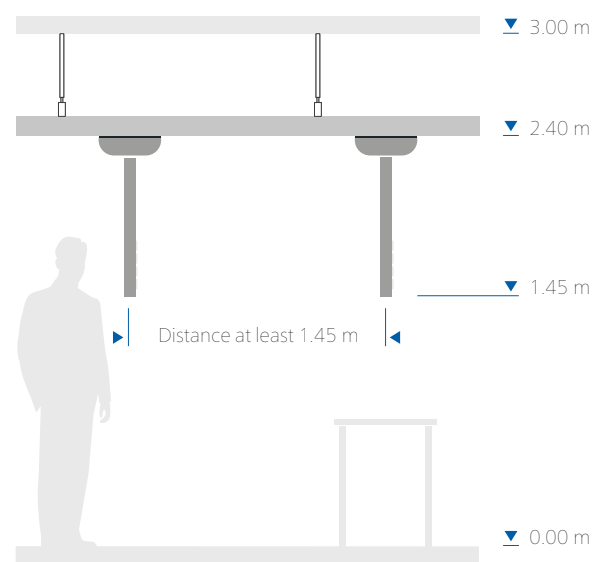



# CONNECTIONS

## CONNECTION CELL



The connection cell is the central interface for all multi-functional rooms and contains the supply terminals or provided by the building owner for the ceiling supply systems. Here, among other things, are the supply terminals for gas (gas safety valves), water, electricity (electrical sub-distribution) and multimedia (EDP Switch).

- + MODULAR CONTROL CENTRE
- + CLEAR DESIGN
- + SAFE OPERATION

**i** A connection cell is combined with any of the ceiling systems.

## POINT EXTRACTION SYSTEM

- + ARTICULATED ARM
- + RE-LOCATABLE TO ANY CONNECTION POINT
- + EASILY REMOVED FOR SAFE STORAGE



## POWER SUPPLY UNIT

- + CENTRALIZED CONTROL AND DISTRIBUTION TO CEILING SYSTEM
- + MOBILE UNIT FOR ULTIMATE FLEXIBILITY





# AquaEL AND MOBILE WATERSTATION

## MOBILE WATER AT EVERY PLACE

Simply transport the AquaEL to the workstation on its trolley or set it up conveniently on the table – and the experiment using water can begin.

- + LIGHTWEIGHT AND MOBILE
- + PERFECT FOR TEMPORARY USE
- + WATER SUPPLY AND WASTE WATER DISPOSAL VIA THE MEDIA WING
- + OPTIONAL TRANSPORT AND STORAGE TROLLEY
- + HIGH CAPACITY SYSTEM WITH DUAL TAPS
- + FULLY MOBILE



AquaEL



Mobile water station

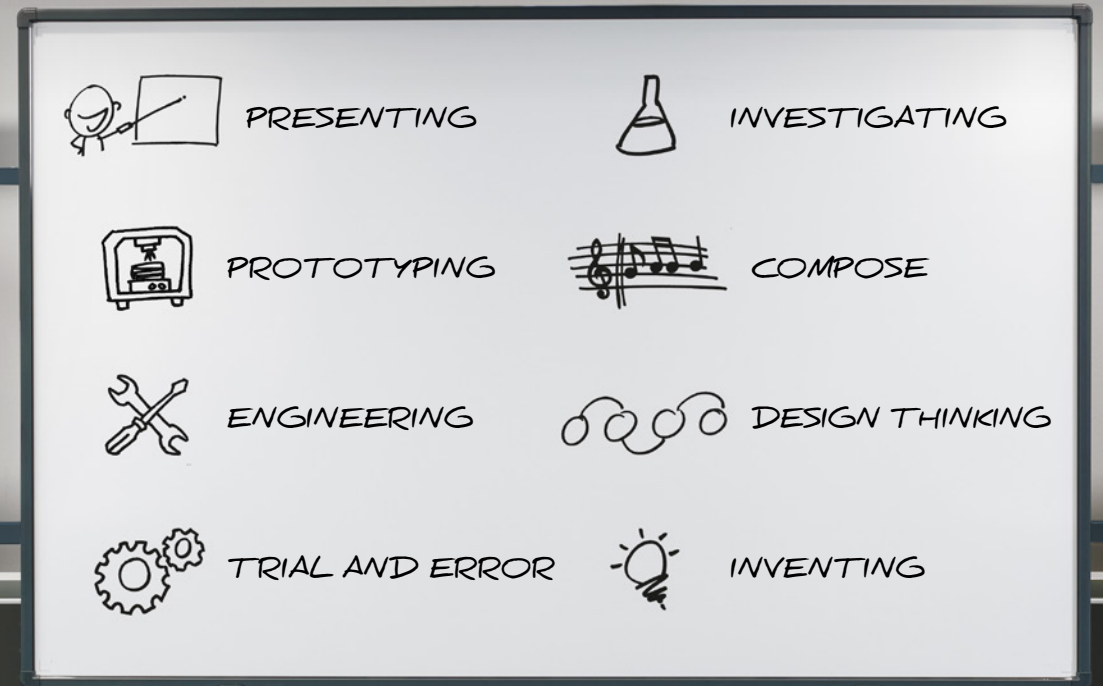
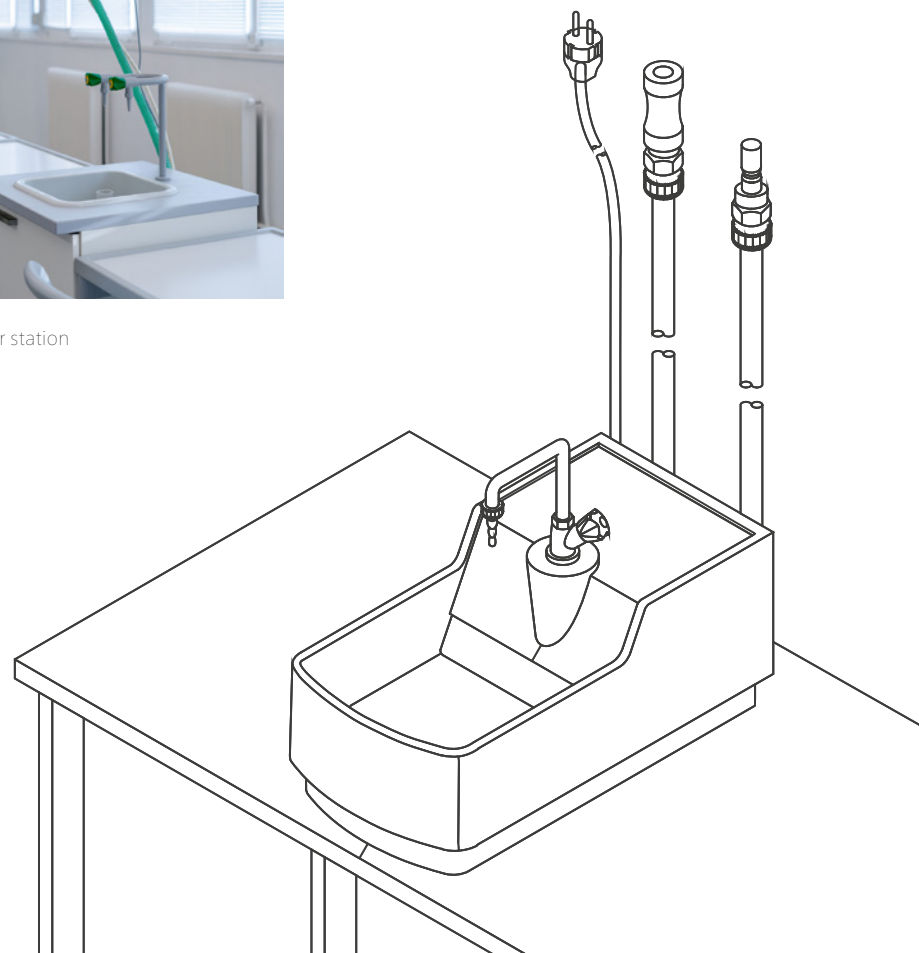

# QUICKBOARD 3

## THE BOARD YOU NEED IS ALWAYS IN FRONT

Our Quickboard 3 pylon board offers the combined use of an interactive surface and classic writing board within the same frame via the easy rotation mechanism.

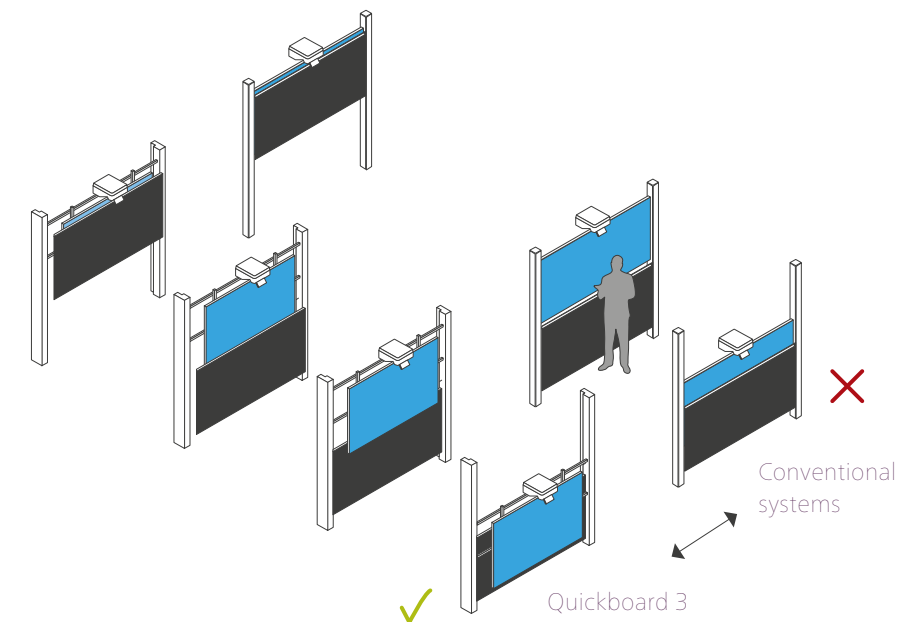

- + PATENTED SWIVEL MECHANISM
- + UNIQUE OPERATING COMFORT
- + MECHANICAL SWIVEL PROTECTION



# AeroEm

## 360° VISIBILITY AND PERFECT SAFETY FOR MOBILE EXPERIMENTS

Our mobile demonstration fume hood with safety glass and gas, water or power supply.

### MEDIA



Gas, power, exhaust air, high volume vacuum, water delivery and removal

- + CAN BE VIEWED SAFELY FROM ALL SIDES
- + CAN BE USED ANYWHERE AND EASILY MOVED FROM ROOM TO ROOM
- + ELIMINATES HARMFUL SUBSTANCES SAFELY AND QUICKLY
- + CONNECTS TO MEDIA WING SYSTEM OR BUILDING EXTRACTION UNIT
- + INDUSTRY LEADING "BEST IN CLASS"

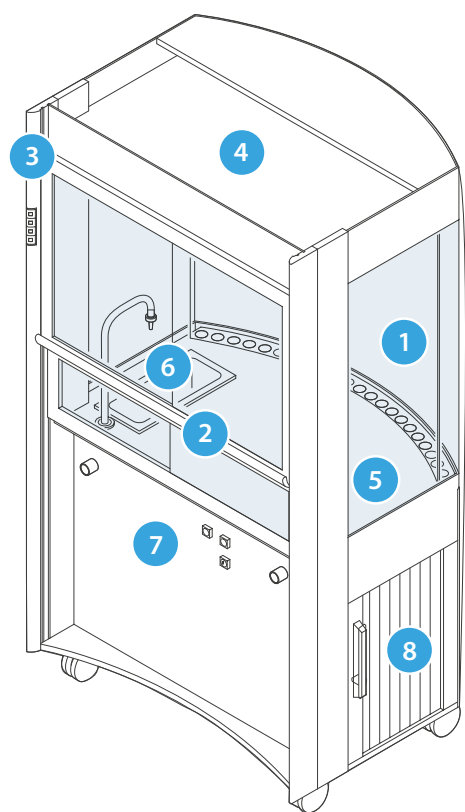

- 1 All viewing panels made of safety glass and are easily cleaned
- 2 Two moveable horizontal sashes
- 3 Function & safety display panel
- 4 Glare free interior lighting
- 5 Stoneware composite worktop
- 6 Variety of media supply and extraction options
- 7 External operating controls
- 8 Roller shutter on both sides of storage area





„You can never cross the ocean unless you have the courage to lose sight of the shore.“  
Christoph Kolumbus



# SEDIAMO CHAIRS

## ROBUST, ERGONOMIC AND MOBILE

Our Sediama chair collection offers a variety of frame styles and sizes that meet the needs of teachers and students.

- + ERGONOMIC AND HEALTHY SEATING
- + VARIOUS SEATING POSTURES AND SIZES
- + LIGHTWEIGHT AND STACKABLE FOR TEACHERS AND STUDENTS







# TEACHERS TABLES

A traditional teacher desk or change the perspective and demonstrate exciting experiments in front of the class.

- + FULLY MOBILE EXPERIMENT TABLE WITH HEAVY DUTY CASTORS
- + VARIETY OF BASE UNITS AVAILABLE
- + INTEGRATED AND HEIGHT ADJUSTABLE SAFETY GLASS FOR SPLASH PROTECTION

# COLLABORATION TABLES

Our comfort tables are generous in size but so easy to operate and relocate making them perfect for every situation.

- + MOBILE STANDING/SITTING WORKSPACE
- + SIMPLE HEIGHT-ADJUSTMENT: JUST USING ONE HANDLE
- + IMPROVES CIRCULATION
- + UP TO 10 SEATS

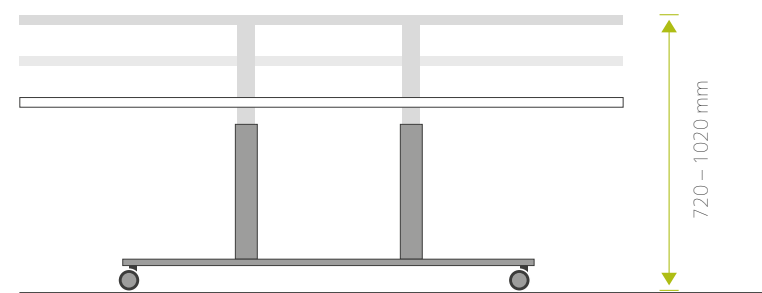
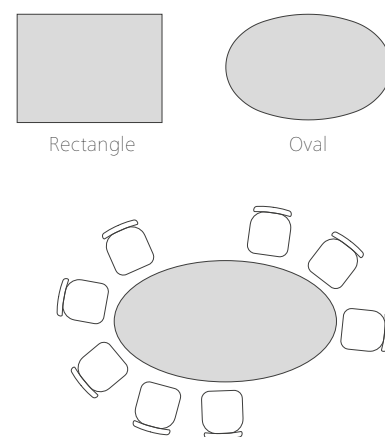

„The role of the teacher has changed from pure knowledge provider to mentor or learning guide.“

Andreas Schleicher  
OECD director and  
PISA developer



# STUDENT TABLES



## OPTIONS



Satchel hook



Cable duct



Steel basket shelf



Cable outlet

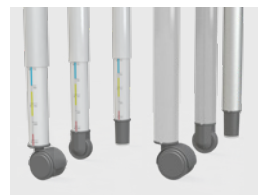

Different table frame options

Our Combo modular tables in a wide range sizes and materials are the perfect solution for every classroom and laboratory.

- + HEIGHT-ADJUSTABLE, LIGHTWEIGHT AND STACKABLE
- + MODULAR AND MOBILE
- + VARIETY OF FRAME STYLES AND FINISHES FOR DIFFERENT REQUIREMENTS
- + PERFECTLY MATCHED TO OUR FLEXLEARN STORAGE, ACCESSORIES AND SEDIAMO CHAIRS
- + RANGE OF ACCESSORIES FOR EASY STORING







## PERFECTLY ORGANISED

Self-organised learning requires a wide variety of materials at the workspace. Decide whether you will work with worksheets, topic folders or collections of materials, the FlexLearn interior adapts perfectly.



# STORAGE

CABINETS DO NOT HAVE TO BE BORING

- + MOBILE FLEXLEARN FURNITURE WITH A VARIETY OF COLOURS AND DIMENSIONS
- + HANDY EXPERIMENT PREPARATION AND PRACTICAL ORGANISATION
- + HIGH VOLUME STORAGE POSSIBILITIES FOR ALL DEMANDS
- + HIGH QUALITY & LONG LIFE CONSTRUCTION





# ALL-IN-ONE CABINETS FOR HAZARDOUS MATERIALS

- + ABSOLUTE SAFE STORAGE FOR DIFFERENT CHEMICALS
- + VENTILATED & FIRE RATED CABINETS
- + EASILY ACCESSIBLE SHELVING FOR GENERAL STORAGE
- + MOBILE UNITS FOR HEAVY ITEMS

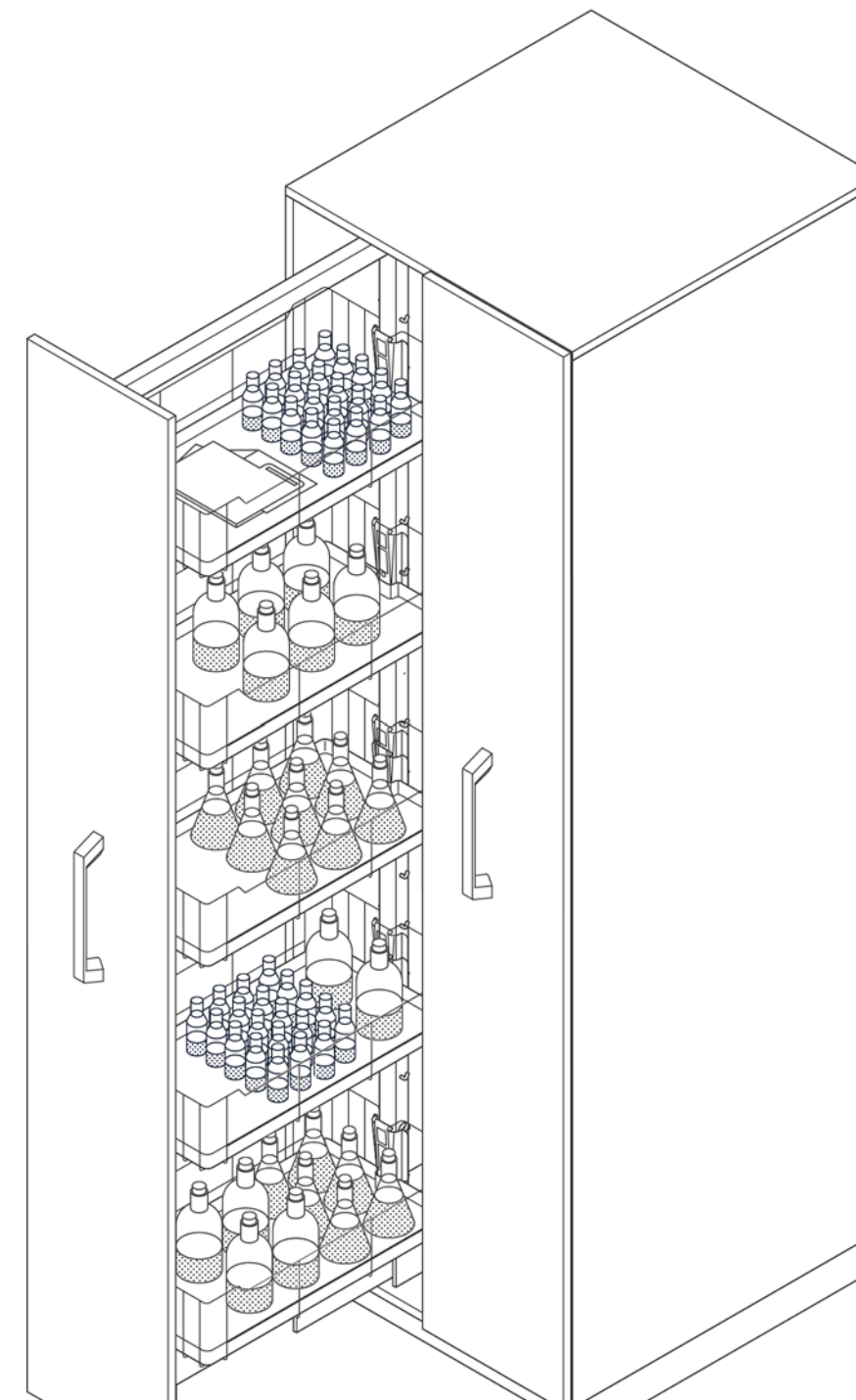



# WORK SURFACES

## TABLE TOP VARIATIONS



25 mm work surface  
melamine coated oak,  
3 mm PP edge oak



25 mm work surface  
melamine coated off-white,  
3 mm PP edge off-white



25 mm work surface  
0.8 mm HPL coated oak,  
3 mm PP edge oak



25 mm work surface  
0.8 mm HPL coated off-white,  
3 mm PP edge off-white



30 mm work surface  
0.8 mm HPL coated off-white,  
3 mm PP edge off-white



10 mm work surface  
Solid core white,  
bevelled edge black



19 mm work surface  
Solid core white,  
bevelled edge black



30 mm work surface  
Ceradur white,  
7 mm PUR beaded edge light grey

# COLOURS

## METALLIC COLOURS



White aluminium  
RAL 9006



Orange  
similar RAL 2000



Apple green



Ocean blue  
similar RAL 5015

## COLOURS FOR SEAT SHELLS



Light grey



Orange  
similar RAL 2000



Apple green



Ocean blue  
similar RAL 5015





# CHOOSE THE BEST TABLE TOP FOR YOUR NEEDS

## MELAMINE RESIN COATING

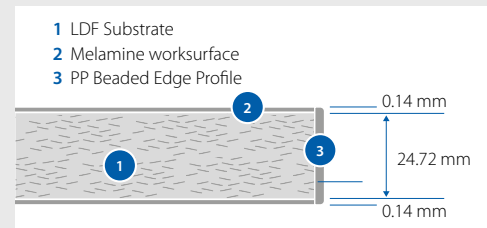

Recommended use	Standard non-science rooms
Critical substances	Acids in concentrations > 10 %
Destructive substances	Concentrated muriatic acids, nitric acid, heated sulphuric acid
Advantage	Flat, smooth, scratch-resistant, reasonable price
Limitation	Moisture-sensitive joints Average chemical resistance

## HPL

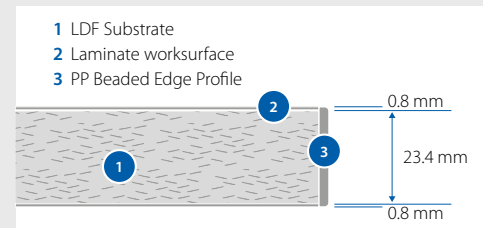

Recommended use	Office rooms and physics
Critical substances	Acids in concentrations > 10 %
Destructive substances	Concentrated muriatic acids, nitric acid, heated sulphuric acid
Advantage	Flat, shock-protected, more durable than melamine
Limitation	Moisture-sensitive joints Average chemical resistance

## SOLID CORE

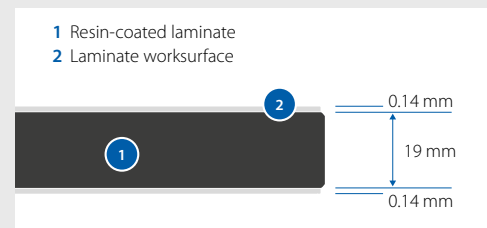

Recommended use	Physics, Biology
Critical substances	Acids in concentrations > 10 %
Destructive substances	Concentrated muriatic acids, nitric acid, heated sulphuric acid
Advantage	Moisture-resistant, flat, damp-proof
Limitation	Low coating thickness

## CERADUR

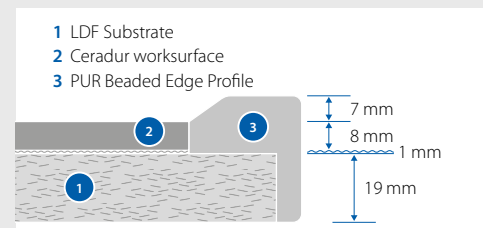

Recommended use	Wet areas, chemistry
Critical substances	none
Destructive substances	Hydrofluoric acid
Advantage	Flat, lighter than stoneware, best chemical resistance, moisture resistant, heat resistant
Limitation	Thermodynamic stressing limited

# ACHIEVEMENTS

## AWARDED FOR PRODUCT INNOVATION

Numerous patents, brands, design patents and registered designs clearly deonstrate our innovation.



## PROFESSIONAL PRODUCTION FOR SAFE ROOM SETUPS

Quality right down into the detail is defined not only by our claims about what we do but by what we achieve. We manufacture in accordance to International quality standards and are flexible enough to be able to support special technical & design requirements.



## CHAIR SIZE REFERENCE

Size	Body height	Seat height	Table height
● Size 5	1.46 – 1.77 m	430 mm	710 mm
● Size 6	1.59 – 1.88 m	460 mm	770 mm
● Size 7	1.74 – 2.07 m	510 mm	830 mm





Ceiling grid, ventilation technology, air-conditioning, lighting, sanitary and electrical installations

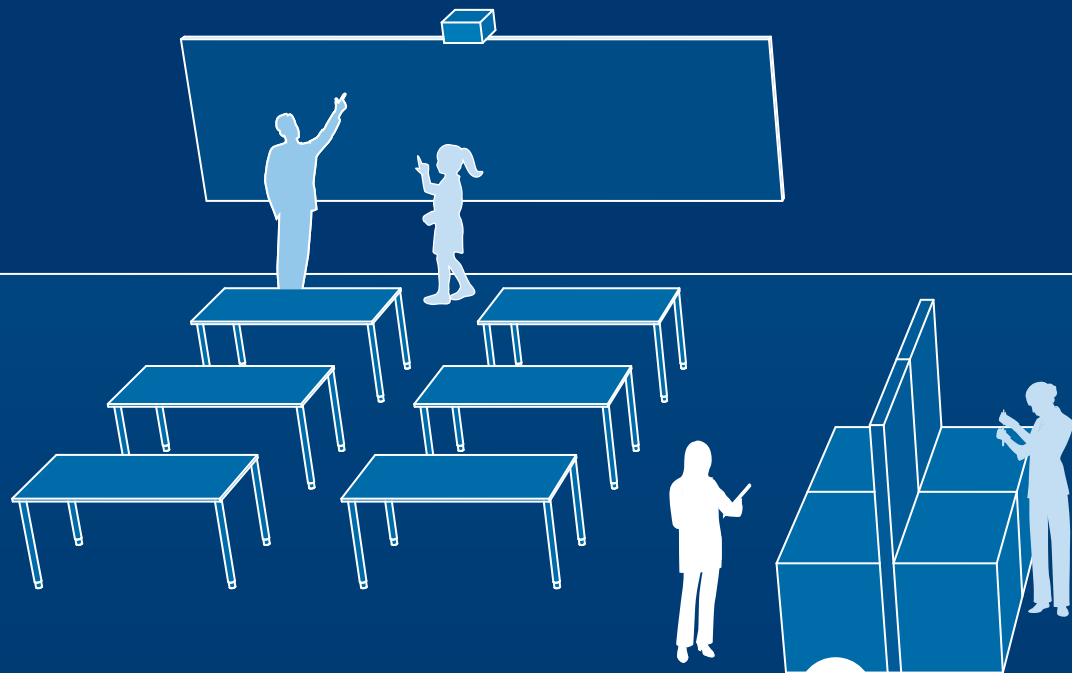

Laboratory workspaces and special fume hoods

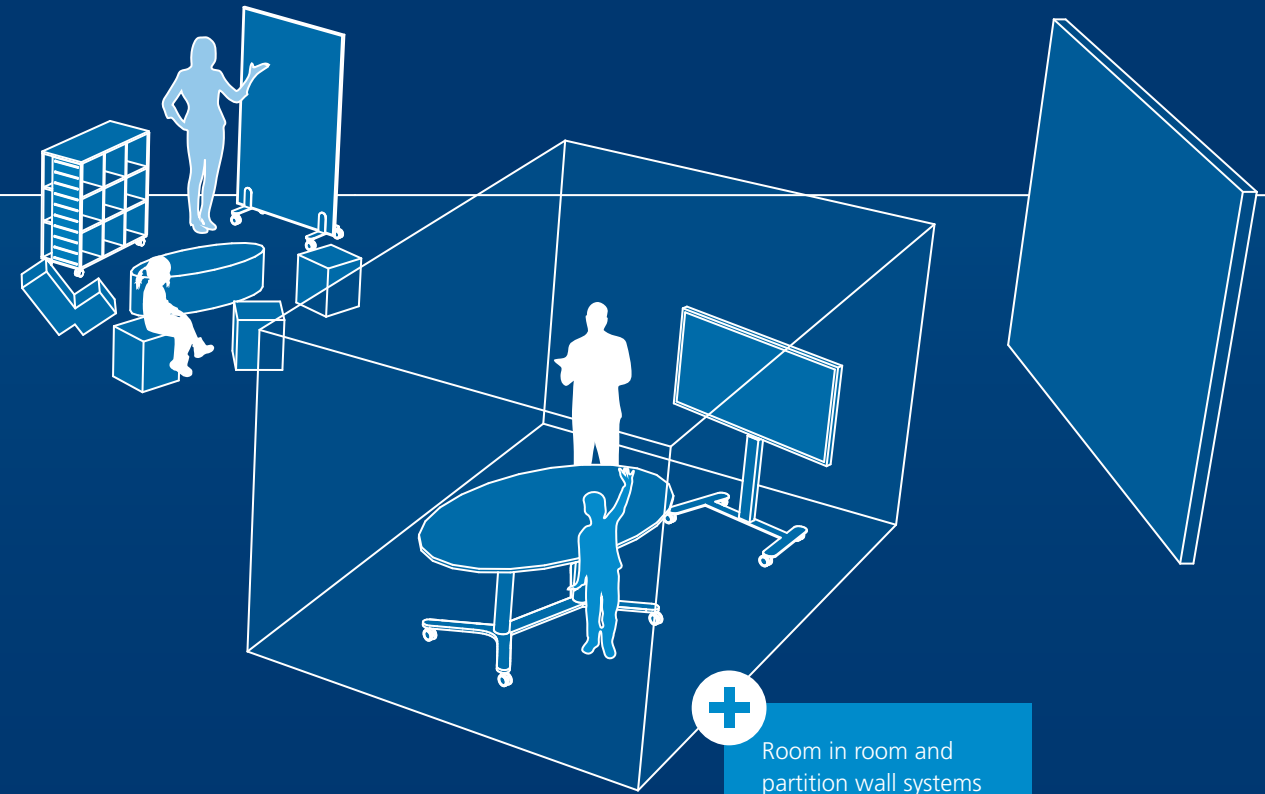

Room in room and partition wall systems

# LOOKING AHEAD DESIGNING THE FUTURE

Within our group of companies we offer you many other tailored products and services. Talk to us – we combine your wishes to an holistic and operationally ready All-in-One solution: maximum flexibility and expandable at any time.



WALDNER LABORATORY SYSTEMS

High tech laboratories for research and industry

[www.waldner-lab.de](http://www.waldner-lab.de)



DIMENSIONS

All-in-One solutions for sustainable, technical infrastructure

[www.waldner-dimensions.de](http://www.waldner-dimensions.de)





Your learning spaces  
for tomorrow's  
education.

Are you ready?

WALDNER Laboreinrichtungen GmbH & Co. KG  
Haidesch 1, 88239 Wangen, Germany  
Tel.: +49 7522 986-480, Fax: +49 7522 986-418,  
education@waldner.de , www.waldner-education.com

**WALDNER**

1564.1219